

# ION GATEWAY

## Wireless Temperature Sensor



### General Description

The RF Wireless Temperature Sensor uses a type NTC thermistor to measure temperature.

### Features

- Accurate to  $\pm 1.8^\circ \text{F}$
- Increased accuracy by user calibration to  $\pm 0.45^\circ \text{F}$
- Ion Gateway basic online wireless sensor monitoring and notification system to configure sensors, view data, and set alerts via SMS text & email.

### Principle of Operation

The Ion Gateway Wireless Temperature Sensor outputs the ambient temperature in degrees Fahrenheit. It is programmed to sleep for a user-given time interval (heartbeat) and then wake up, send power to the NTC Thermistor and wait for it to stabilize, and convert the analog data, mathematically compute temperature and transmit data to the gateway. To stay within the abilities of the processor, the temperature is computed off a data table provided by the manufacturer. To reduce error, a variable resistor configuration is implemented over specified temperature ranges.

### Power Options

Sensors are powered by a replaceable 3.0 V coin cell battery.

It is recommended that you set the heartbeat to no faster than one hour to preserve battery life.

### Ion Gateway Sensor Core Specifications

- Power: Replaceable 3.0 V coin cell battery
- Dimensions 1.775" x 1.040" x 0.785"
- Antenna: 4" wire
- Operating Temperature:  $-20^\circ$  to  $60^\circ \text{C}$  ( $-4^\circ$  to  $140^\circ \text{F}$ )
- Device Range: 250 - 300 ft. non-line-of-sight\*
- Battery Life: At 1 hour heartbeat setting, coin cell battery will last ~ 1-2 years.\*\*

\* Actual Range may vary depending on environment.

\*\* Battery life is determined by sensor reporting frequency and other variables.

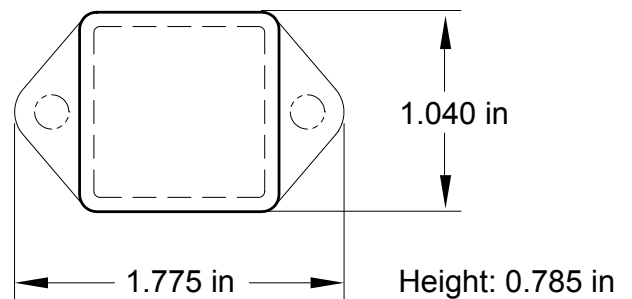

### Applications

- Ambient Temperature Monitoring
- Environment Monitoring
- Smart Machines & Smart Structures
- HVAC Operation & Testing
- Data Center Monitoring



# ION GATEWAY

## Wireless Temperature Sensor

Technical Specifications	
Supply Voltage	2.0 - 3.6 VDC *
Current Consumption	0.7 $\mu$ A (sleep mode) 2 mA (radio idle/off mode) 2 mA (measurement mode) 25 mA (radio RX mode) 35 mA (radio TX mode)
Operating Temperature Range (Board Circuitry and Coin Cell)	20°F to 140°F **
Optimal Battery Temperature Range (Coin Cell)	50°F to 122°F
Thermistor Temperature Range (Thermistor Only)	-40°F to 257°F (Limited to Main Unit Circuitry, -19°F to 140°F unless wire leads are being used.)
Accuracy @ 77°F	+/- 1% (1.8° F)
User Calibrated Accuracy	$\pm$ 0.45° F
Time Constant @ 77°F	30 sec

\* Hardware can not withstand negative voltage. Please take care when connecting a power device.

\*\* At temperatures above 212°F, it is possible for the board circuitry to lose programmed memory.

### Caution/Notice:

This product is designed for application in an ordinary environment (normal room temperature, humidity and atmospheric pressure). Do not use this sensor under the following conditions as these factors can deteriorate the product characteristics and cause failures and burn-out.

- Corrosive gas or deoxidizing gas - chlorine gas, hydrogen sulfide gas, ammonia gas, sulfuric acid gas, nitric oxides gas, etc.).
- Volatile or flammable gas.
- Dusty conditions.
- Under low or high pressure.
- Wet or excessively humid locations.
- Places with salt water, oils chemical liquids or organic solvents.
- Where there are excessively strong vibrations.
- Other places where similar hazardous conditions exist.

Use this product within the specified temperature range. Higher temperature may cause deterioration of the characteristics or the material quality of this product.

